

Sacred Garden Project



The Sacred Garden Project will create a place of peace and tranquillity for all pilgrims.

This will encompass a Remembering Space to reflect and renew, an upgrade of the fountain and rill and the addition of a bronze globe - a symbol of the worldwide Mercy family, and an invitation 'to care for our common home'.

The Memory wall will be renewed, displaying beautiful ceramic plaques with the art of Sr Clare Augustine Moore. An interactive Learning Area for groups to gather will separate the garden into two distinct spaces.

To complement all of this, there will be trees and plantings, benches and lighting to foster an atmosphere of contemplation, rejuvenation and awareness.

Sacred Garden Project Summary

Remembering Space

Our vision is to create a reflective atmosphere in the Sacred Garden around Catherine's burial site. Cost: €32,500 including the paving throughout the entire Sacred Garden, displaying the names of those first fifty sisters buried in the garden, seating for reflection and rest, and complementary planting.

Memory Wall

The Memory Wall will undergo structural work and renewal; all previous plaques will be restored. Cost: €30,000 – restoration and structural work to the wall and incorporation of ceramic plaques of the artwork of Sr Clare Augustine Moore.

Fountain and rill

A new globe structure will be designed and begin the rill, €23,000 is the estimated cost. To bring the rill and pool to garden level will cost €28,000. The pool area will be in the new Learning Space; this part of the upgrade is €17,000. The pumps and pipework will come to €34,000. Total cost is €105,500.

Learning Area

A lift will be installed to provide access; this will cost €23,000. The ground area will be lowered, an amphitheatre style seating area will be created, along with new steps, the cost is €25,000. The planters to soften and encourage a lovely welcome to the space will cost €4,500. Total cost: €52,500.

Trees, benches and lights

Plants, lighting and benches to rest and contemplate will bring joy to the visitors of the Sacred Garden. Total cost: €49,500.

The total cost for all the above projects for the Sacred Garden is estimated at €270,000 which is USD \$320,000.

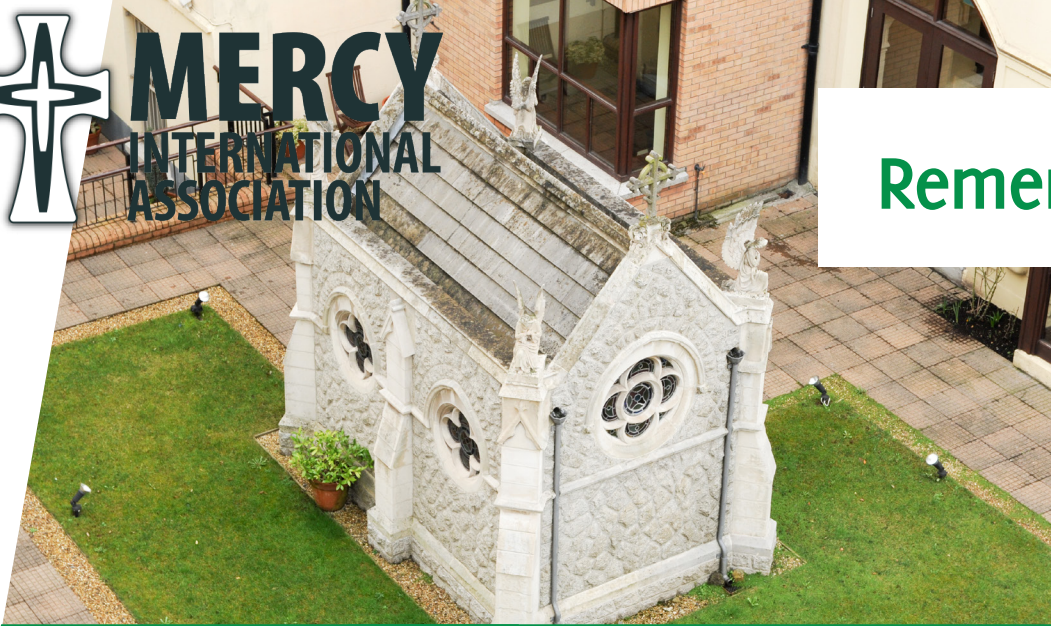

The structure built over Catherine's grave and the surrounding area will be developed into a Remembrance Space.

The area will include the names of the Sisters who are buried in the garden and will acknowledge the contribution to Mercy mission by all deceased Sisters of Mercy and Partners in mission worldwide.

The Architect's impression of the area shows the use of selective planting to give privacy to the space for those wishing to pause and remember and pray.

The Project funding will encompass

The provision of seating

The display of the names of those buried in the garden

Planting to create a reflective atmosphere.

New paving/paths in the garden to allow for universal access and continuous movement around the Sacred Garden. Paths will be paved in small scale setts: presenting an attractive, gentle setting along which visitors can walk around the garden, whatever the weather.

The lower area will be paved in polished concrete.



The Cost

The estimated cost for the benches and panels to display the names of those remembered in this space is €4,500.

The paving throughout the entire garden is estimated at €28,000

Memory Wall

The Memory bricks are an important feature of the Sacred Garden. These will be retained.

The area will be enhanced with feature lighting, improved access, and the restoration of the plaques.

The wall will be relocated to the Herbert St side of the Sacred Garden and the plaques will be attractively

arranged along with artwork such as ceramic tiles of the work of Sr Clare Augustine Moore, to make the space more visually appealing.

There will be scope on the memory wall to continue to add further plaques.

The relocated wall will be at the base of the memory wall.



The Project

This project will include structural work to create the new Memory Wall.

Restoration and relocation of the existing plaques, or recreation of the content of them in a new way.

Development of the ceramic tiles or other such artwork as a feature of the wall.

The wall and associated art work will be integrated into the base of the wall.

Complementary planting.

The names of all donors of the Sacred Garden Project will be incorporated into the Memory Wall.

The Cost

The Wall Construction and reinstatement of plaques has an estimated cost of €23,000.

Each of the ceramic plaques of the work of S Clare Augustine Moore is expected to cost €1,000, it is anticipated that there would be at least six to add colour to the wall and make it more attractive.

Fountain and Rill

The fountain and rill are important features of the Sacred Garden that need to be retained.

There will be a new Globe sculpture designed, depicted in the Architect's sketch (below right), from which water will flow into a rill running alongside the edge of the redesigned memory wall. This will mean that it will not be a safety hazard and therefore not require the large unattractive protective blocks currently surrounding it.

The water will then go underground and eventually cascade into the pool that is in the learning area of the garden.



The Project funding will encompass:

The new commissioned Globe sculpture to begin the rill.

A new water pump/mechanism to allow the water to flow and be recycled through the system.

The building of the rill and lining of it in materials to complement the garden design and link in with the sculpture.

The building of the pool area in the learning space.

The Cost

The rill and pool at garden level is estimated at €28,000
The bronze globe that would begin the water feature is estimated at €23,000.

The pumps and pipework is approximately €34,000

The pool at the end of the rill and the spout for the water to come in would be €17,000.

Bronze work along the edges of the rill will incorporate Catherine's sayings and is estimated at €3,500.

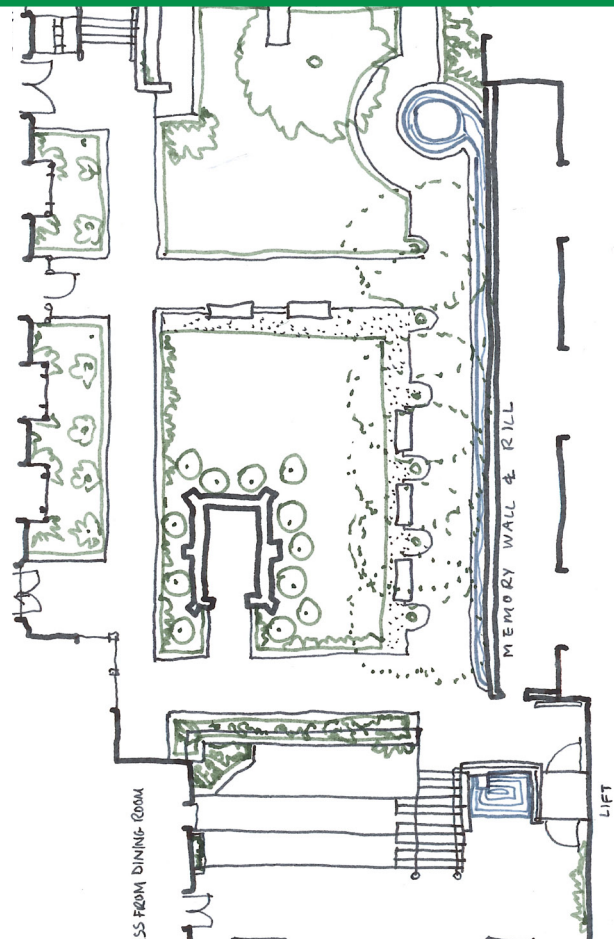



MERCY
INTERNATIONAL
ASSOCIATION

Learning Area



The lower level of the garden will be redesigned to create a learning area.

The architect's sketch shows the formation of an amphitheatre to be used for groups. Lowering the ground level of this area will enable direct access to the dining room and also create the opportunity for the dining room to extend out into the courtyard. A lift for mobility access will be installed to the right of the new stairs.

Removing the steps will enable direct access from the house for those with mobility challenges. It will also facilitate easy movement of a large portable multimedia screen with interactivity options such as Google Jamboard for optimum learning.

The area will include a variety of plants to soften the space and make it more welcoming.

The Project includes:

The removal of the current steps and the lowering of the ground level in this area.

The provision and installation of a mobility lift.

The installation of doors from the dining room.

The creation of amphitheatre seating area, as well as the new steps up to the second level.

Other movable seating to provide opportunities for group work in the lower courtyard.

The planting in this area.



The Cost

The platform lift to allow universal access would cost €23,000

The various construction costs for the amphitheatre and steps to create this space and the doors to the dining room is estimated at €25,000.

A series of planters, integral to the design of this area will be €4,500

Trees, benches and lights

To deserve the name garden, the inclusion of planting is important.

A line of silver birches will create a new dimension to the garden and complement plantings along the existing back wall of the garden.

Coupled with the sound of running water through the rill, the plantings will help to create a space where creation can be appreciated and pilgrims can reflect on their commitment to Earth.

Additional benches throughout the garden will provide places for visitors to rest a while for reflection and dialogue, and lighting will ensure the space is usable at different times of the day.



The Project funding will encompass:

A line of silver birches filters the view to the modern building to the south east side of the garden. The beds at the lower level will be planted with lush green architectural planting, suitable to the shady location. The end wall of the garden, sheltering where the statue of Catherine sits, will be enhanced with espalier fruit trees, offering blossoms in spring and fruits in autumn. Elsewhere plants will be selected to bring natural form and life to the garden, soften the hard built edges of the garden, and bring joy to visitors.

The Cost

The planting of the silver birches is estimated at €9,000
Additional benches are costed at €2,000
Lighting of the garden is an extensive project at €38,500

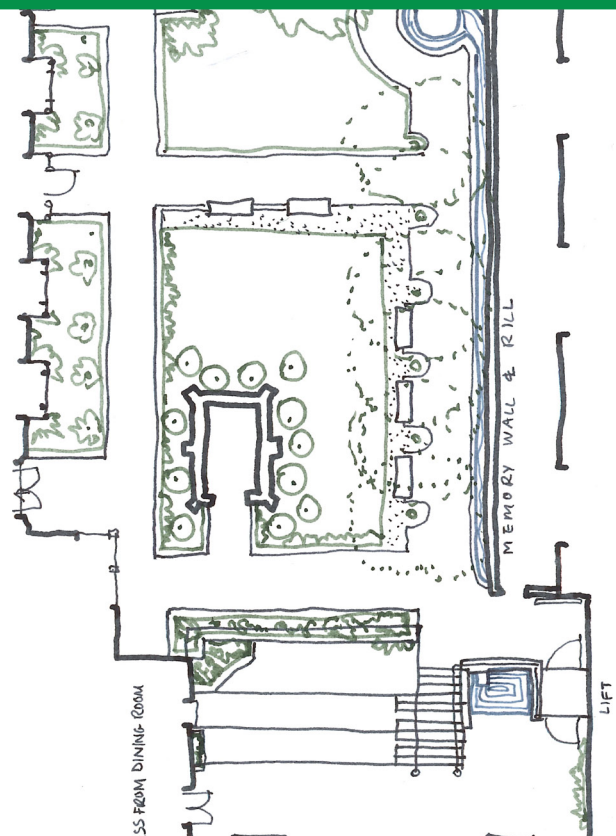

Upgrading the Doyle Room



The Doyle Room can be acknowledged as our first Mercy hospital in the same way that the International Room is recognised as our first Mercy classroom.

Original plans for Catherine's House identify this room as the infirmary. It can therefore be considered as the birthplace of compassionate Mercy healthcare that today reaches across all the continents

of the world.

Facilities, comparable to those in the International Room, including the installation of touch-screens, will enable a more complete telling of the healthcare dimension of the Mercy story.



The Project

To upgrade the physical space in keeping with the International Room and provide modern conference facilities including a sound system with a hearing loop, a large interactive display screen, and video conferencing equipment, and suitable furniture for meetings.

Four touch screens will be installed around the room that will display the story of compassionate Mercy healthcare, its beginnings in the room itself, the Cholera epidemic, the Apothecaries hall, the Crimean War, the building of the first Mercy Hospitals as well as the story of healthcare throughout the Mercy world today.

The room is named after Anna Maria Doyle, who professed her vows alongside Catherine McAuley and was one of the first to live in the House when it was built. Her story will continue to be told in this room through the screens and artefacts.

The Cost

The upgrade of the International Room 4 years ago cost approximately €100,000 (USD\$120,000), the same amount is being sought for the upgrade of this room. This amount is part of the overall build quotation from EPIC and Emotion Media.



MERCY
INTERNATIONAL
ASSOCIATION

Heritage on display



Mercy International Centre holds a precious collection of artefacts associated with Catherine McAuley.

A number of very special items are on permanent loan to the Mercy International Centre, including Catherine's Profession Ring and her cincture.

Additionally, the documentation and story of the formation of Mercy International Association in 1992 is part of the archival collection.



The Project

The Heritage Room now needs to cater for a new generation of pilgrims to the Centre who are familiar with and attracted by modern technology as well as the written word. The intention is to redesign the room with the use of fixed panels to extend the display area available and enable more of the early story of Mercy to be told through the displays. The panels are to include a number of touch screens that enable some of the heritage resources from the different Mercy Congregations to be show-cased.

The provision of a large touch screen will enable access to the letters of Catherine, their content and provide the ability to sort the letters by destination of the letter, who the letter was to and other features. There is potential to expand this to also display some of the letters of the other early women of Mercy who travelled the world and continued the letter writing tradition of Catherine McAuley as they established Congregations.

Part of the room is currently a replica of a small hovel depicting the types of homes that the Sisters visited in the early days of the Congregation. This room will become a venue for a multimedia experience with videos and displays that enable the visitors to have a clearer, more immediate understanding what life was like in 19th Century Dublin.

The Cost

EPIC and Emotion Media have provided a quotation of €250,000 (USD \$300,000) for the technological build as well as the development, exhibition build, electronic screens and installation of the project.